

MANUAL

WARNING LIGHT - LED LIGHT HEAD

RED = +VDC

BLACK = - TO CHASSIS GROUND

GREEN = CHANGE PATTERN AND SYNCHRONIZE

1. Apply RED wire to +VDC.
2. For flash pattern: Momentarily apply GREEN wire to +VDC, the flash pattern will advance to next one.
3. For synchronization: Connect GREEN wire of all lighthoods together. All lighthoods should be set at the same flash pattern.

FLASH PATTERNS

1	Single flash (R65)	Amber	14	Strobe	White
2	Single flash California	Amber	15	Alt. Amber - White, single flash	
3	Double flash	Amber			
4	Quad	Amber			
5	Combo single/triple	Amber			
6	Combo single/quint	Amber			
7	Strobe	Amber			
8	Single flash (R65)	White			
9	Single flash California	White			
10	Double flash	White			
11	Quad	White			
12	Combo single/triple	White			
13	Combo single/quint	White			

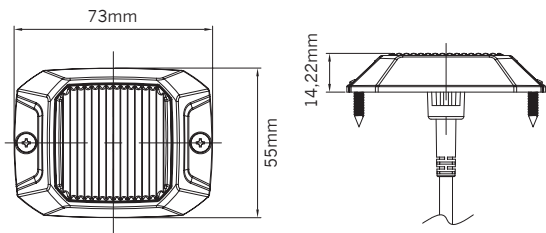

Part no. 850204HP-A

Contact us if you need support: support@strands.se or +46(0)320-450450



www.strands.se
www.strandseurope.com